

GRAND HOTEL

BIRMINGHAM



MEETINGS & EVENTS

Beautifully restored and bursting with "wow factor", the Grand Ballroom is once again opening its doors to some of Birmingham's most glamorous occasions.

Our nine additional meeting and event spaces combine period character with the latest technology, while our team of chefs can cater to every need, from business breakfast and working lunch to a four-course feast. If you're looking for a show-stopping event space in a city-centre location, there's nowhere quite like The Grand Hotel Birmingham.

ROOM NAME	THEATRE	CLASSROOM	CABARET	U-SHAPE	BOARDROOM	DINNER	RECEPTION	DIMENSIONS
GROUND FLOOR								
GRAND BALLROOM	250	-	140	-	-	175	250	28.4 x 11m; h 8.6m
HORTON	-	-	-	-	-	-	25	-
FIRST FLOOR								
BALLROOM BALCONY	-	-	-	-	-	20	-	20 x 3.4m; h 4.4m
CATHEDRAL	26	10	12	-	8	15	26	8 x 8m; h 3.5m
COLMORE	34	16	12	-	11	15	34	8.2m x 7m; h 4.6m
CHURCH	53	21	21	-	14	30	53	10.6 x 9m; h 3.2m
REGENT	30	12	12	-	8	15	30	7.6 x 6.8m; h 4.4m
ALBION	-	-	-	7	7	7	15	6.6 x 3.6m; h 4.4m
CHAMBERLAIN	-	-	-	7	7	7	15	6.8 x 3.6m; h 3.3m
TEMPLE	56	21	21	-	8	30	112	15 x 5.8m; h 4.2m
BARWICK	-	-	-	-	7	7	15	8.2 x 6.2m; h 3.6m



HOW TO FIND US

By Air	Birmingham Airport 11 miles
By Rail	Birmingham New Street station 0.3 miles (direct trains to / from London every 20 mins) Birmingham Snow Hill station 2 minutes
Parking	Snow Hill Station car park 2 minutes (open 6am - 11.30pm; Sunday 8am - 9pm) CP Londonderry House 0.4miles (open 24 hours)
Post Code	Birmingham B3 2BS

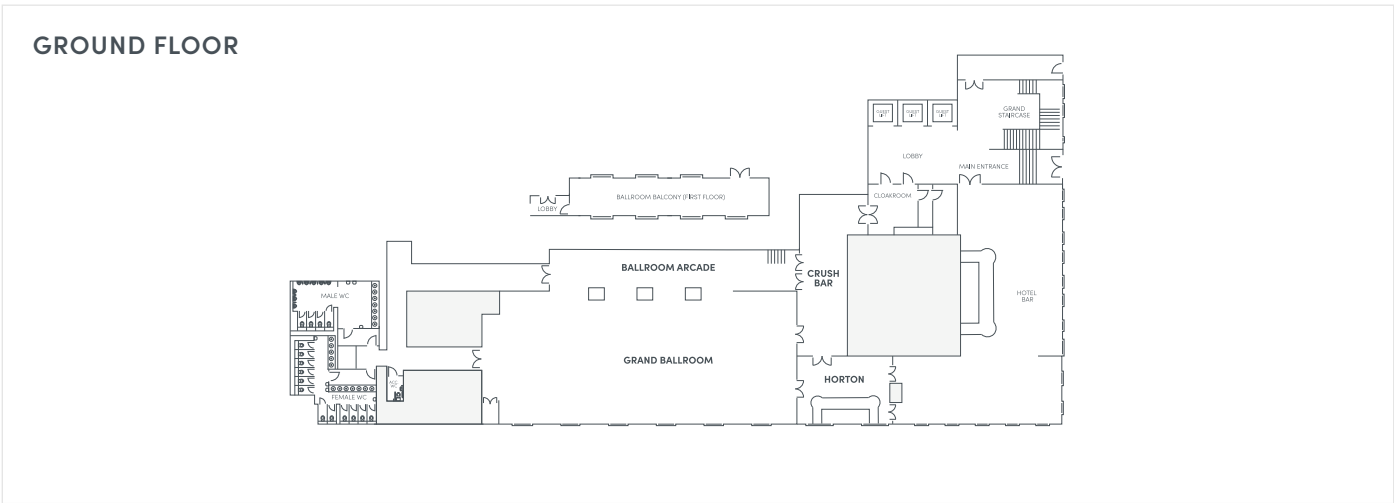
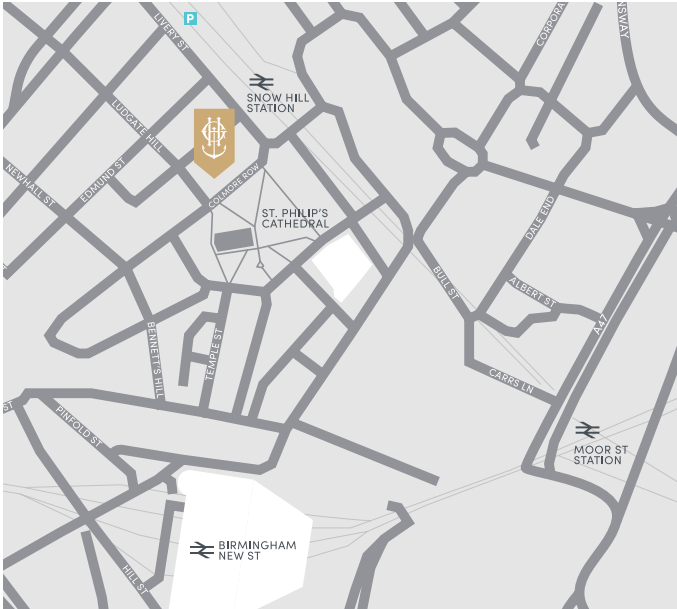

IN PARTNERSHIP WITH

